

Must be dumpster owner applying for permit and agreeing to terms of permit.



**CITY OF JANESVILLE, WISCONSIN
BUILDING & PLANNING DIVISIONS
DUMPSTER PERMIT APPLICATION**

DATE: _____ PERMIT # _____ PARCEL # _____

LOCATION: Street Alley Sidewalk Terrace

PROPERTY SERVED: _____

PROPERTY OWNER NAME: _____

PROPERTY OWNER ADDRESS: _____ PHONE # _____

DUMPSTER OWNER: _____ OFFICE PHONE # _____

ADDRESS: _____ EMERGENCY PHONE # _____
(i.e., Removal Purposes, Snow, etc.)

REASON FOR DUMPSTER: _____

DATE OF PLACEMENT: _____ DATE OF REMOVAL: _____
(2 week maximum)

DUMPSTER OWNER SIGNATURE: _____

I hereby certify I am the dumpster owner and authorized agent of the above-mentioned "Property Served" listed for placement of the dumpster. Said dumpster will be placed in accordance with the information referenced on this application and will be in accordance with all applicable laws of the State of Wisconsin and City of Janesville.







APPROVED BY: _____

REQUIREMENTS FOR PLACEMENT OF DUMPSTERS IN THE PUBLIC RIGHT-OF-WAY

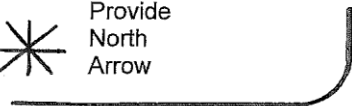
- (1) The name of the company responsible for placement and removal of waste dumpster must be displayed on dumpster.
- (2) Dumpsters may not be placed in traffic lanes.
- (3) In the event of a declared snow emergency, dumpster shall be immediately removed from the public way until plowing operations are complete.
- (4) Dumpsters may not be placed in illegal parking spaces. Examples are within 15' of crosswalk areas, 10' of hydrants, or 4' of driveway approaches.
- (5) Dumpsters may not extend more than 8 feet into the roadway from the face of the curb and shall be placed flush to the curb.
- (6) Dumpsters shall be set back 60 feet from any intersecting cross street curb line.
- (7) Dumpsters shall be delineated on the traffic approach side with one Type II or III barricade or traffic drum with an attached flashing yellow light (see details on back).
- (8) Dumpsters placed in alleys must be placed to allow a minimum of 11 feet for traffic to maneuver around the dumpster. Both ends of dumpster must be delineated as in Item 7 above. Dumpsters placed in alleys must not block fire exits nor be placed under fire escapes.

PLACEMENT OF DUMPSTER

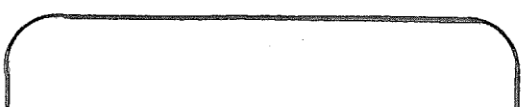
(Provide a detailed location of dumpster with distance from street corners, property lines, and driveways.)

 Provide North Arrow			
			

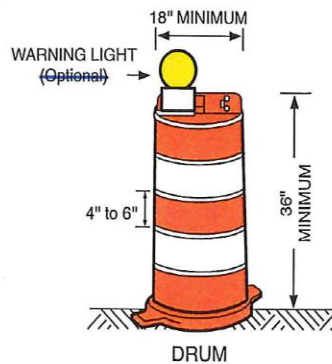
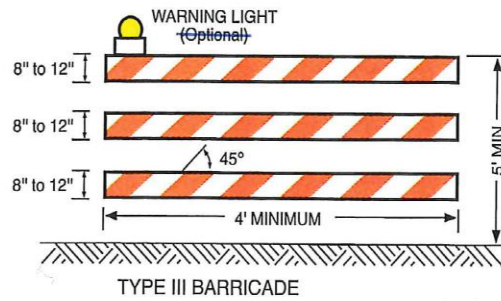
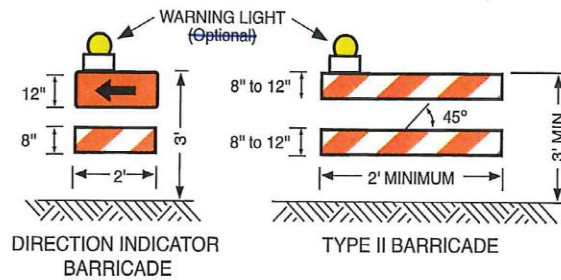

Notes

1. Stripes on barricade rails shall slope downward at an angle of 45 degrees toward the direction traffic is to pass.
2. Barricade rail stripe widths shall be 6 inches except where rail lengths are less than 36 inches, then 4 inch wide stripes may be used.
3. The sides of barricades and vertical panels facing traffic shall have retro-reflective rail faces. Drums, cones, and tubular markers shall have retro-reflective bands as shown above.

This is an example of how to show where the dumpster will be placed by using the diagram on the bottom of the permit application form.

PLACEMENT OF DUMPSTER

(Provide a detailed location of dumpster with distance from street corners, property lines, and driveways.)

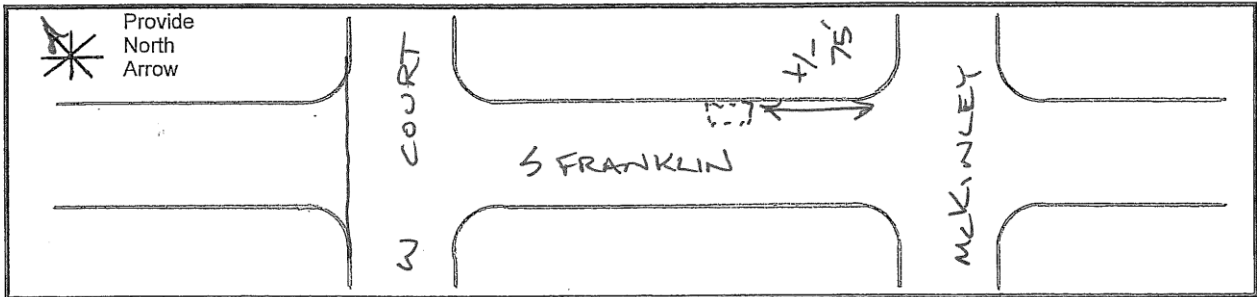

An aerial map can also be used to sketch where the dumpster will be placed. To use our City website mapping, go to www.ci.janesville.wi.us

